



## CONSUL HOUSE, E3

£2,100 PER MONTH

- Top floor flat
- Allocated off-street parking
- Loft storage
- Spacious Apartment

wj.  
meade

# Consul House

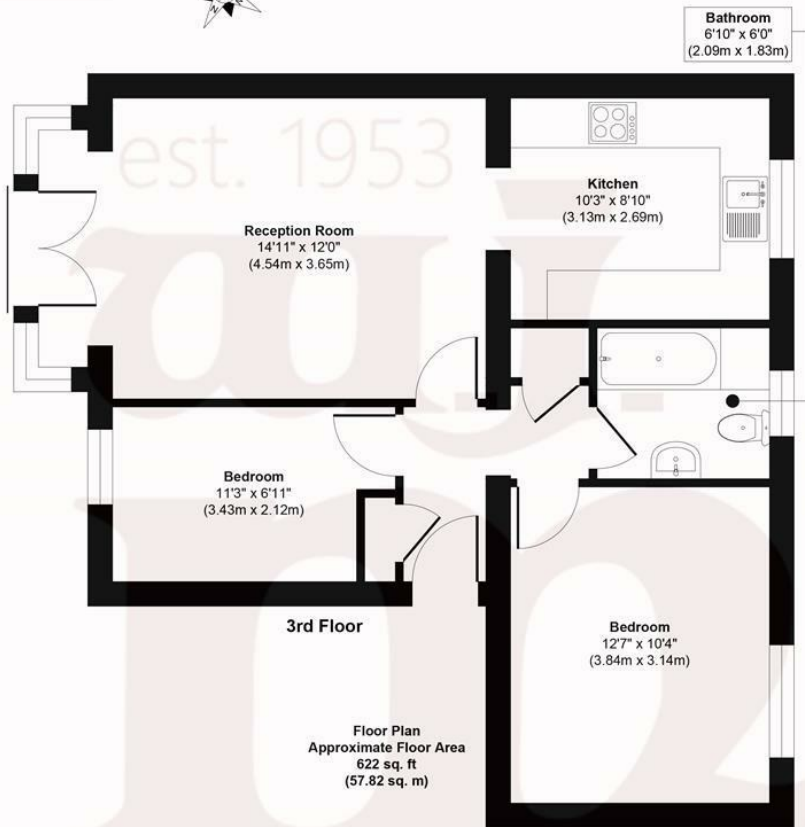

**Approx. Gross Internal Floor Area 622 sq. ft / 57.82 sq. m**

Illustration for identification purposes only, measurements are approximate, not to scale.  
Produced by Elements Property



WJ Meade are pleased to offer this well presented two bedroom apartment within a small private development. Situated on the top floor, the property is well designed to include a modern fitted kitchen, separate reception room with Juliet balcony, hallway with storage cupboards and a recently upgraded bathroom suite. Well positioned for access to Bow Road underground station as well as a variety of local amenities including public green spaces, cafes and shops.

Deposit is 5 week's rent.

Service charge £n/a

Ground rent £n/a

Reserve fund £n/a

n/a years lease

Council tax band D

Current EPC Rating 75

Tenure:



All sizes are approximate. The Agent has not tested any apparatus, equipment, fixtures and fittings, or services and so cannot verify that they are in working order or fit for the purpose. A buyer is advised to obtain verification from their Solicitors or Surveyor. Photographs are for illustration purposes only and may depict items, which are not for sale or included in the sale price. References to tenure of a property are based upon information supplied by the vendor. The agent has not had sight of the title documents, a buyer is advised to obtain verification from their solicitor. Money Laundering Regulations 2003: Intending purchasers will be asked to produce identification, documentation at a later stage and we would ask for your co-operation in order that there will be no delay in agreeing the sale.

These particulars are intended to give a fair description of the property only and are in no way guaranteed, nor do of any contract. They are issued on the express condition that all negotiations are conducted through W.J. Meade Estate Agents. All subject to contract and to being unsold.